

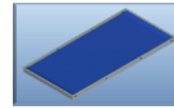

THE NEW ALUMINIUM SERIES

ALS 1000



**Full-Plate
AL Absorber**

An ideal combination of highly selective aluminium absorber and copper tubes.



**Prismatic-figured
Tempered Glass**

Prismatic figured tempered glass avoids diffusion of sunrays and is strongly resistant to outside forces



**High-Strength
Case**

Anodized aluminium case with screwless design maximizes rigidity and provides excellent resistance to corrosion.



**Enhanced
Insulation**

Super-high density rock wool insulation minimizes the heat loss despite the slim design of the collector.



ALS 1000

Collector Diameters	2145 mm x 1045mm x 77,5 mm
Collector weight (empty)	37 kg
Tube Material	Copper
Tube Diameter (mm)	8
Number of Tubes	9
Manifold Material	Copper
Manifold Diameter (mm)	18
Gross Area	2,24 m ²
Net Area	2,08 m ²
Absorber material	Copper with Aluminium Selective Sheet
Absorbitivity	95%
Emissivity	5%
Solar liquid capacity	1,55 lt
Glass	4 mm. Solar glass (prismatic structure)
Number of connections	4
Connection measurement	3/4 "
Max. Operating pressure bar	6
Insulation	Rock wool 60 kg/m ³ - 30 mm